



- ARCHITECTS
- INTERIOR DESIGNERS
- PROJECT MANAGEMENT CONSULTANTS

COMPANY PROFILE 2024



CONTACT US:

☎ 022 2582 1898 / 022 4783 6329 📞 98213 46171 / 77383 17171

✉ akriticonsultant001@gmail.com / abasahebdesai@gmail.com

📍 JAYDEEP EMPHASIS, UNIT 101, PLOT NO. A-9, M.I.D.C. ROAD, NEXT TO HOTEL GOPALASHRAM, WAGLE ESTATE, THANE (W) 400 604.



CONTENTS

1	COMPANY PROFILE	01
	- THE FIRM	
	- SERVICES PROVIDED	
	- TEAM	
	- INFRASTRUCTURE SUPPORT	
2	REDEVELOPMENT PROCESS & PMC ROLE	03
3	SCOPE OF WORK	04
	- ARCHITECTURAL SERVICE	
	- PROJECT MANAGEMENT SERVICE	
4	LIST OF PROJECTS	07
	- REDEVELOPMENT PROJECTS	
	- GREENFIELD PROJECTS	

11 MILLION+ SQ. FT. OF SPACES DESIGNED SUCCESSFULLY
50+ PROJECTS COMPLETED
40+ PROJECTS ONGOING

25 YEARS OF EXPERIENCE





PRIYA CHS LTD.
REDEVELOPMENT PROJECT

“Redevelopment is need of the hour for the citys growing population and better lifestyle of the rersidents”

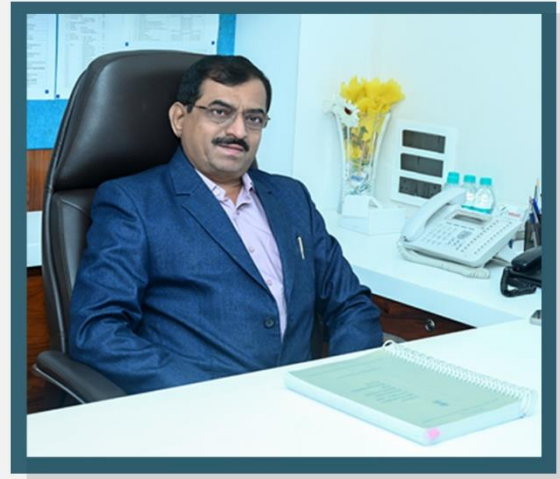

Ar. Abasaheb Desai
Principal Architect, Proprietor

THE FIRM

Akruti Consultants is a design firm that seamlessly integrates architectural excellence with innovation. Established in 1999 we've been pioneers in architectural design for past 25 years, combining creativity with technical expertise to turn visions into reality. Based in Thane we have projects running across various cities like Thane, Mumbai, Navi Mumbai and surrounding Mumbai Metropolitan region.

With a diverse portfolio ranging from Residential Complexes and Townships to I.T. Offices, Commercial, Educational, and Religious institutions our firm showcases proficiency in tackling an array of design challenges. Through projects of varying scales and complexities, we demonstrate our expertise in delivering innovative solutions tailored to each unique context.

We offer comprehensive services including planning consultation, authority approvals, site supervision, and Project Management consultation for growing redevelopment projects. With a dedicated team, we tailor bespoke solutions for you, collaborating closely with clients and consultants to unlock each project's full potential from inception to completion, ensuring exceptional design and seamless delivery.

OUR SERVICES

THE FIRM EXPERTISE TO SERVE ALL ARCHITECTURAL SERVICES FOR SUCCESSFUL COMPLETION OF DEVELOPMENT PROJECT. RANGING FROM INITIAL FEASIBILITY ANALYSIS, EFFICIENT DESIGN & PLANNING, LIAISONING FOR AUTHORITY APPROVALS, PREPARING GFC DRAWINGS & COMPLETE SITE SUPERVISION AND PROJECT MANAGEMENT CONSULTANCY (REDEVELOPMENT).

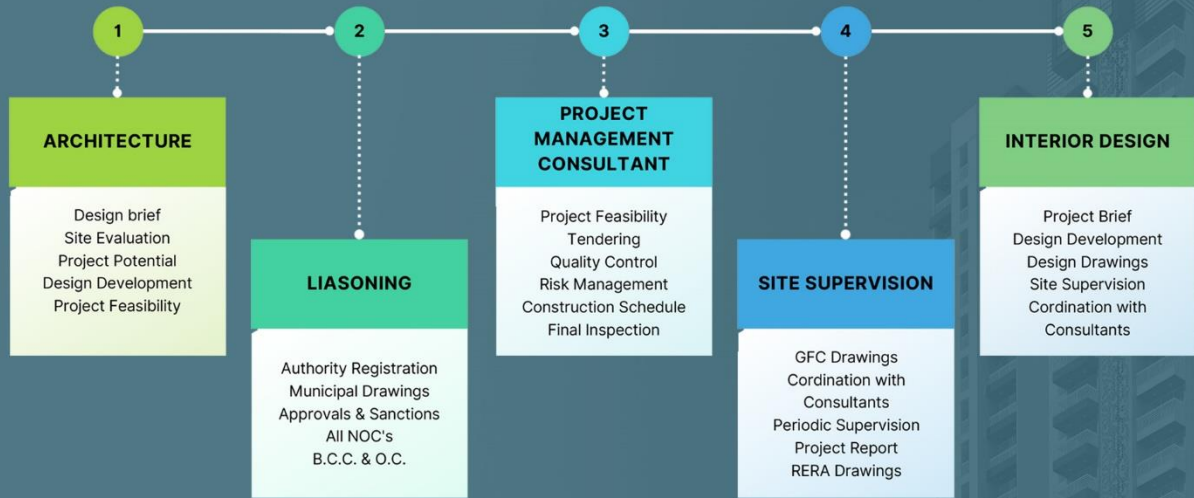

THE TEAM

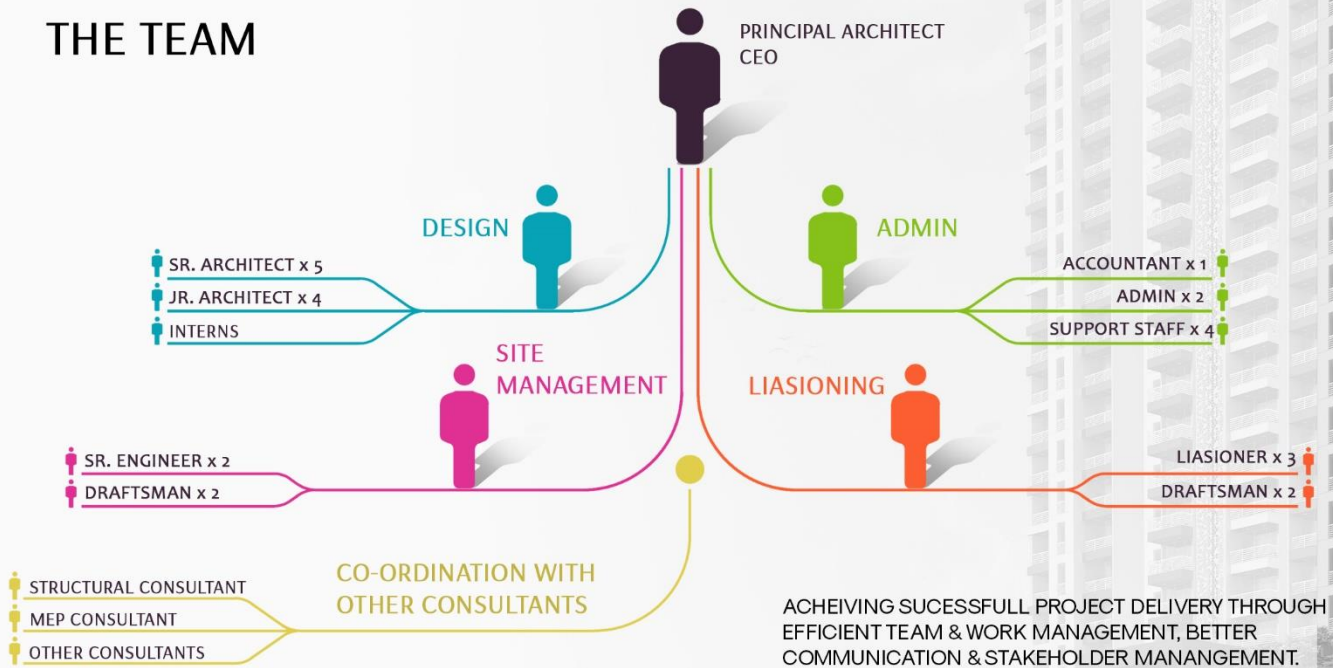

WORKSPACE EFFICIENCY

UPDATED IT RESOURCES FOR ACHIEVING DESIRED WORK QUALITY AND PROJECT GOALS. KEEPING IN TRACK WITH CHANGING AUTHORITY APPROVAL SYSTEMS TO AVOID DELAYS IN PROJECT COMPLETION.



REDEVELOPMENT OF HOUSING SOCIETIES

The changing economic scenario, land crunch, and soaring real-estate prices in cities have resulted in inflation in the sector. Old buildings – the haphazard and disorganised construction planning of the past is seeing several homes on the verge of collapse, giving rise to imminent risk and safety concerns for its residents.

A structure constructed in the 70s and 80s generally goes through stages of repair, giving rise to safety concerns for its residents. However, such structures should be carefully accessed and redeveloped instead. Besides, compared to repairs, redevelopment is more sustainable. Repairing any building that is 25 years old will increase its life only by three or four years. It is not structurally or economically feasible. Redevelopment is the need of the hour that requires momentum and it is essentially the perfect solution for both the supply side and demand side. In fact, redeveloping residential societies would play a key role in the 'smart city' mission.

However, the procedure is not without its hassles. Residents in cities like Mumbai & Thane, where redevelopment is rampant, are facing issues because of delayed deliveries of the re-developed projects. PMC appointment helps society for a more convenient and guided project followup to avoid risks and make redevelopment project successful.

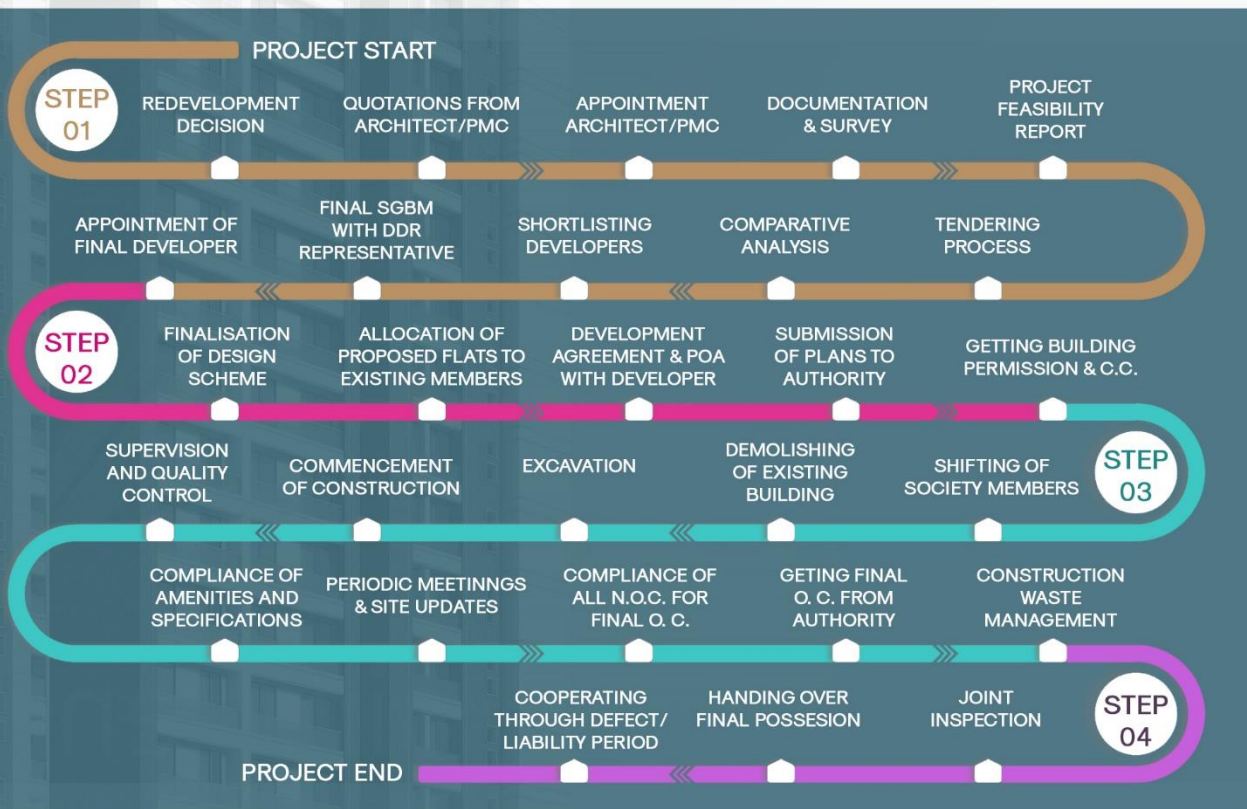

PMC - SUPERVISION AT DIFFERENT PROJECT STAGES



SCOPE OF WORK

ARCHITECTURAL SERVICE

DESIGN & APPROVAL

1. Preparing detail project case to understand feasibility of project and getting all documentation done required for approval submission.
2. To prepare conceptual planning scheme of floor plans, master layouts, elevations, 3d visuals and sections in multiple options before the society finalises one to proceed ahead.
3. As per instructions from society preparing presentation plans with area statements.
4. Preparation of municipal drawings in compliance with the authority and UDPCR norms.
5. Preparation of fire compliance drawings as per CFO norms and getting their NOC.
6. Preparation of drawings for Auto-DCR / BPMS as per the requirements.
7. Submission and approval of plans online and getting Building Permission / C.C. in time.
8. Intimating authority for plinth completion as per the UDPCR norms.
9. Preparing drawings for amended municipal approval for any design changes if required further.
10. To provide required drawings and documents for taking various NOC's, as and when required.
11. Getting final Occupation Certificate on completion of project as per the approved drawings.

SITE EXECUTION

12. Preparation of Advanced working drawings as per approval for Society and implementing any modification as per their requirements. (Only PDF)
13. Preparation of Sale Plans and required drawings for submissions to RERA.
14. Providing Work completion certificate for RERA and Bank purpose at required time.
15. Preparation of Final Architectural working drawings set including demarcation, centre-line, all floor plans, sections and elevations, all required details.
16. Preparation of internal layout, door and window schedules finishes schedule, colour scheme, flooring and wall tile patterns for building and structures.
17. Preparation of drawings for main Entrance lobby and typical floor lobby interior.
18. Preparing Site plans including contour grading, location for Septic, U.G. & Fire Tank, Substation if required, D. G. Set.
19. Details for Driveway and Parking, Compound wall and Gates, Illumination design, Graphic design and Signage.
20. Checking for Plot & Plinth demarcation, Centre line (above and below ground level).
21. Checking for U.G., Fire & Septic Tank, all services layout at ground level as per drawing.
22. Checking for Plinth beam at ground level, Column starter and Staircase above ground level.
23. First slab Centring checking and all side projection as per approval drawing.
24. All floor level slab and projection checking as per approval drawings.
25. Checking for Terrace slab, Elevation design structure, OHT & LMR top-bottom slab.
26. Brickwork checking at all floors and as per working drawing.
27. All services (Electrical, Plumbing, Mechanical, Fire, etc.) checking in coordination with MEP consultants.
28. Coordination with RCC and other (Parking, Landscape, Lift, Solar, etc.) consultants till project completion.
29. Checking for all floor plans, open spaces, all O.C. compliance requirements before application for final BCC/OC.
30. Obtaining NOC's from Water, Drainage and Tree department for final O.C.
31. Obtaining Final Building Completion Certificate (O.C.) from Authority.



PROJECT
FEASIBILITY

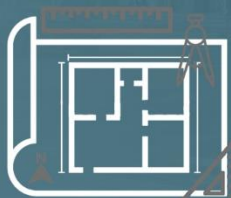

DESIGN
DEVELOPMENT



AUTHORITY
APPROVALS



SITE
SUPERVISION

SCOPE OF WORK

PROJECT MANAGEMENT SERVICE

PREPARING FEASIBILITY REPORT

1. To examine the documents available with society such as Conveyance Deed, 7/12 extract, C.C. & OC. of existing buildings, etc. to confirm that the society is eligible to go ahead for a feasible redevelopment process.
2. To get the Physical Table land Survey and Internal Flats Survey done and prepare a report on the Existing property.
3. To obtain information for available FSI, TDR, Redevelopment Incentive as per prevailing Regulation of respective Authority for the respective project.
4. Prepare Detailed Feasibility report for the redevelopment project of the Society considering all the factors such as percentage of additional free carpet area, Transit Accommodation Charges, etc.
5. Getting the report approved from the Society Committee to move ahead in the redevelopment process for Developer selection.

TENDERING PROCEDURE

6. Preparing Tender Draft for the Redevelopment procedure and getting it approved from the Society.
7. Executing Tender Procedure to receive competitive Bid offers.
8. Preparing Comparative charts based on the Bid offers received and submitting the same to the Society.
9. Shortlisting of 3 Bid offers from the total received after joint discussion with the Society Committee.
10. Assisting Society for Selection of final Developer from the shortlisted ones.
11. Final SGBM in the presence of Society Members, PMC and Authorised DDR representative for the Selection of Final Developer and appointing him.

PLANNING STAGE

12. Co-ordinating with Society, Developer and Architect to prepare floor plans options as per the requirement of the Society's members.
13. Coordinating with Architect to get changes done in floor plans as per the suggestions and modification from Managing Committee.
14. After finalising the floor plans, getting them signed from the Managing Committee and keeping a set of plans with society and PMC respectively.
15. Coordinating with Society, Developer, Architect on Municipal Approval Process for getting C.C. and Keeping Society Updated on it.

CONSTRUCTION PHASE

16. To make sure all the drawings such as working, structural, electrical, plumbing, etc. are good to move ahead.
17. Monitoring and examining the construction progress on decided schedule monthly or quarterly.

18. Getting lab tests done from developer like soil test, cube test, etc. on periodic basis and submitting same reports to Society.
19. To make sure all the Construction work is as per the sanctioned plans and there is no unauthorised construction on site.
20. To make sure that the construction work, fixture & fittings are as per the specification of materials and quality mentioned in the tender document.
21. Coordinating with Society, Developer, and Architect until getting Final O.C., and all the members getting possession of their individual Shops/Offices/Flats.



PROJECT
PLANNING



STAKEHOLDER
MANAGEMENT



SCHEDULE
MANAGEMENT



QUALITY CONTROL
& MONITORING



SUCCESSFUL
PROJECT DELIVERY



JVM CORNER STONE

REDEVELOPMENT PROJECT

JVM CORNER STONE



**RESIDENTIAL
REDEVELOPMENT**

**COMPLETED PROJECTS - 13
ONGOING PROJECTS - 09
UPCOMING PROJECTS - 10**



Project Name : JVM Corner Stone

Location : Harinivas Circle, Thane (W)

Plot Area – 2357.92 Sq.Mt.

Approx. Cost : 26.65 Cr.

Completion Year : - 2024

Construction Area : 1,90,348 sq.ft.



Project Name : M/s Prime Developer

Location : Chendani , Thane (W)

Plot Area – 708.20 Sq.Mt.

Approx. Cost : 9.50 Cr.

Completion year : 2022

Construction Area : 35,719 sq. ft.



Project Name : Krishna Vihar
 Location : Naupada, Thane (W)
 Plot Area : 584.54 Sq.Mt.
 Approx. Cost : 4.50 Cr.
 Completion Year : 2020
 Construction Area : 19,580 sq. ft.



Project Name : Laabh Neelkanth
 Location : Kharkar Ali, Thane (W)
 Plot Area : 475.80 Sq.Mt.
 Approx. Cost : 2.20 Cr.
 Completion Year : 2019
 Construction Area : 21,621 sq. ft.



Project Name : Sai Lavkik
 Location : Dhobi Ali, Thane (W)
 Plot Area : 227.40 Sq. Mt.
 Approx. Cost : 1.50 Cr.
 Completion Year : 2023
 Construction Area : 10056 sq. ft.



Project Name : Sanskruti
 Location : Charai, Thane (W)
 Approx. Cost : 1.25 Cr.
 Completion Year : 2005
 Construction Area : 11,676 sq.ft.

COMPLETED PROJECTS



Project Name : Neelambari
 Location : Charai , Thane (W)
 Approx. Cost : 1.20 Cr.
 Completion Year : 2007



Project Name : M/s Shree Jani
 Location : Dhobi Ali , Thane (W)
 Plot Area : 476.20 Sq.Mt.
 Approx. Cost : 0.66 Cr.
 Completion Year : 2012
 Construction Area : 19,775 sq. ft.



Project Name : Krishna Heritage
 Location : Charai , Thane (W)
 Plot Area : 492.10 Sq.Mt.
 Approx. Cost : 1.53 Cr.
 Completion Year : 2015
 Construction Area : 16,879 sq. ft.



Project Name : Krishna Niwas
 Location : Naupada , Thane (w)
 Plot Area : 573.58 Sq.Mt.
 Approx. Cost : 1.40 Cr.
 Completion Year : 2011
 Construction Area : 13,130 sq. ft.



Project Name : Sai Janki
Location : Dholi Ali , Thane (w)
Plot Area : 98.70 Sq.Mt.
Approx. Cost : 1.20 Cr.
Completion Year : 2018
Construction Area : 10,056 sq. ft



Project Name : Shri Swami Samarth Infra
Location : Dhobi Ali , Thane (w)
Plot Area : 146.30 Sq.Mt.
Approx. Cost : 1.20 Cr.
Completion Year : 2021
Construction Area : 7,500 sq. ft.



Project Name : Durga Dham
Location : Naupada , Thane (W)
Plot Area : 526.95 Sq.Mt.
Approx. Cost : 9.74 Cr.
Completion Year : - 2024
Construction Area : 17,650 sq. ft.



Project Name : Priya C.H.S. Ltd.
Location : Kharkarali, Thane (W)
Plot Area : 1606.20 Sq.Mt.
Approx. Cost : 21.81 Cr.
Construction Area : 81,612 sq. ft.



Project Name : Dev-Bhakti C.H.S. Ltd
Location : Patlipada, Thane (W)
Plot Area : 1370.00 Sq.Mt.
Approx. Cost : - 20.00 Cr.
Construction Area : - 60,666 sq. ft.



Project Name : Mohan Mahal C.H.S. Ltd.
Location : Panchpakhadi, Thane (W)
Plot Area : 1506.63 Sq.Mt.
Approx. Cost : 11.07 Cr.
Construction Area : 63,267 sq. ft.



Project Name : Kumar Ashish C.H.S & New Shubhada C.H.S. Ltd.

Location : Panchpakhadi , Thane (W)

Plot Area : 1260.04 Sq.Mt.

Approx. Cost : 11.50 Cr.

Construction Area : 48,253 sq. ft.



Project Name : Vishweshwari C.H.S.

Location : Naupada, Thane (W)

Plot Area : 1056.92 Sq.Mt.

Approx. Cost : - 14.00 Cr.

Construction Area : - 51.010 sq. ft.

ONGOING PROJECTS



Project Name : Ratan C.H.S. Ltd.
 Location : Kopri, Thane (W)
 Plot Area : 513.18 Sq.Mt.
 Approx. Cost : 5.0 Cr.
 Construction Area : 22,200 sq. ft.



Project Name : Everest Excellence
 Location : Chendani, Thane (W)
 Plot Area : 218.20 Sq.Mt.
 Approx. Cost : 1.05 Cr.
 Construction Area : 9,900 sq. ft.



Project Name : Ramashankar C.H.S. Ltd.
 Location : Kharkarali, Thane (W)
 Plot Area : 389.60 Sq.Mt.
 Approx. Cost : 4.11 Cr.
 Construction Area : 15,890 sq. ft.



Project Name : M/s. Mangal Enterprises
 Location : Dhobi Ali , Thane (W)
 Plot Area : 206.50 Sq.Mt.
 Approx. Cost : 2.60 Cr.
 Construction Area : 12,550 sq. ft.



Project Name : Sukhdarshan C.H.S.Ltd

Location : Devdaya Nagar, Thane (W)

Plot Area : 2900 Sq.Mt.

Approx. Cost : - 102.00 Cr.

Construction Area : 2,92,500 sq. ft.



Project Name : Devendu C.H.S.

Location : Kopri, Thane

Plot Area: 1,990.30 Sq.Mt.

Approx. Cost : - 68.85 Cr.

Construction Area : 2,92,500 sq. ft.



Project Name : Shiv Prabha C.H.S. Ltd.

Location : Majiwade, Thane (W)

Plot Area : 1690 Sq.Mt.

Approx. Cost : 17.69 Cr.

Construction Area : 69,470 sq. ft.



Project Name : Hem Deep C.H.S. Ltd.
 Location: Panchpakhadi, Thane (W)
 Plot Area : 464.53 Sq.Mt.
 Approx. Cost : 5.00 Cr.
 Construction Area : 25,600 sq. ft.



Project Name : Arjun Nagar Complex C.H.S.
 Location : Patharli Dombivli
 Plot Area : 3000 Sq. Mt.
 Approx. Cost : 52.20 Cr.
 Construction Area : 1,80,000 sq. ft.

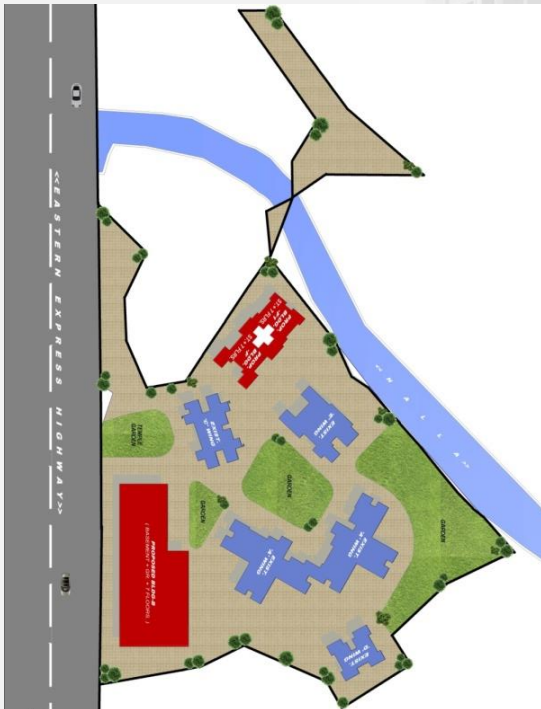

Project Name : Siddhivinayak Tower
 Location : Panchpakhadi, Thane (W)
 Plot Area – 18,130 Sq.Mt.
 Approx. Cost : 251.00 Cr.
 Construction Area : 9,25,200 sq. ft.

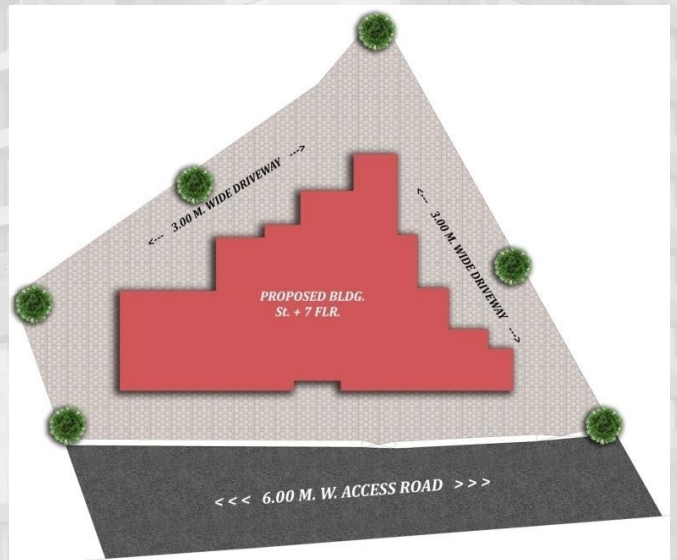

Project Name : Ek Veera C.H.S. Ltd.
 Location : Panchpakhadi , Thane(E)
 Plot Area : 556 Sq.Mt.
 Approx. Cost : 4.66 Cr.
 Construction Area : 12,950 sq. ft.

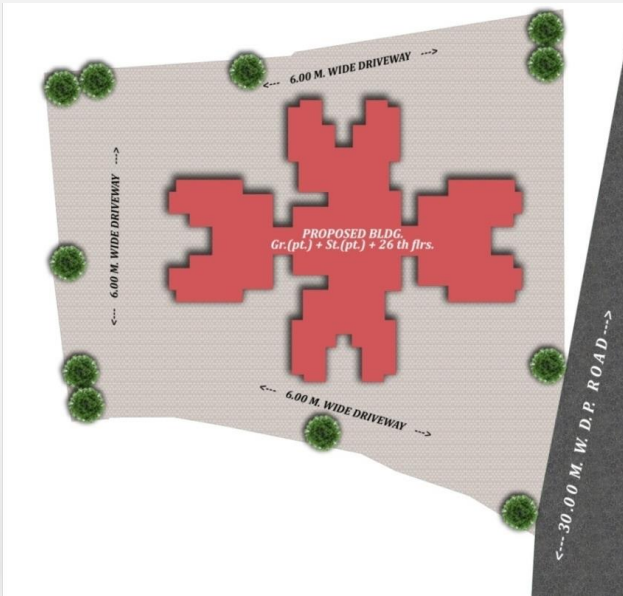

Project Name : Shree Sai Samarth C.H.S. Ltd.

Location : Kalwa, Thane (W)
 Plot Area : 2730 Sq.Mt.
 Approx. Cost : 43.50 Cr.
 Construction Area : 1,55,000 sq. ft.



Project Name : Datar Sadan C.H.S. Ltd.

Location : Kharkar Ali, Thane (W)
 Plot Area : 385.40 Sq.Mt.
 Approx. Cost : 5.00 Cr.
 Construction Area : 19,000 sq. ft.

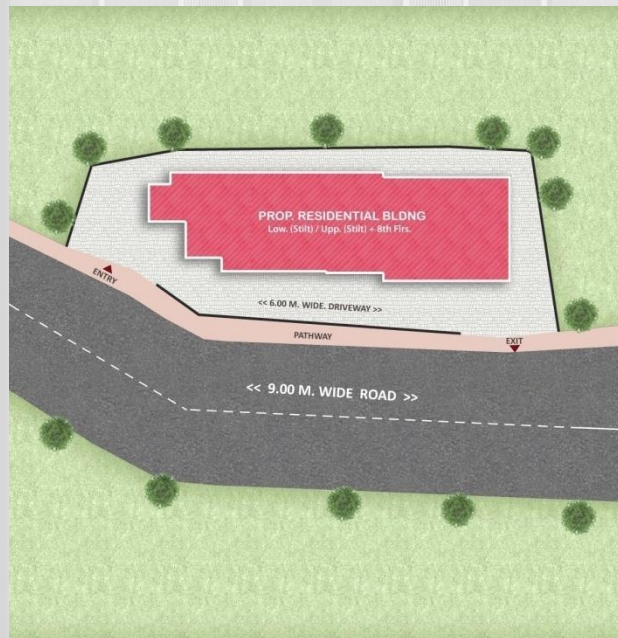

Project Name : Nanda Apartments

Location: Aai Nagar, Kalwa-Thane.
 Plot Area – 510 Sq.Mt.
 Project Cost : 3.60 Cr.
 Construction Area : 13,100 sq. ft.



M/S AMARDEEP CONSTRUCTIONS
GREENFIELD PROJECT





RESIDENTIAL
&
COMMERCIAL

COMPLETED PROJECTS - 36
ONGOING PROJECTS - 18
UPCOMING PROJECTS - 02



Project Name : Flora Residency
 Location : Kasarwadavali, Thane (W)
 Approx. Cost : 19.75 Cr.
 Completion Year : 2019
 Construction Area : 98,840 sq. ft.

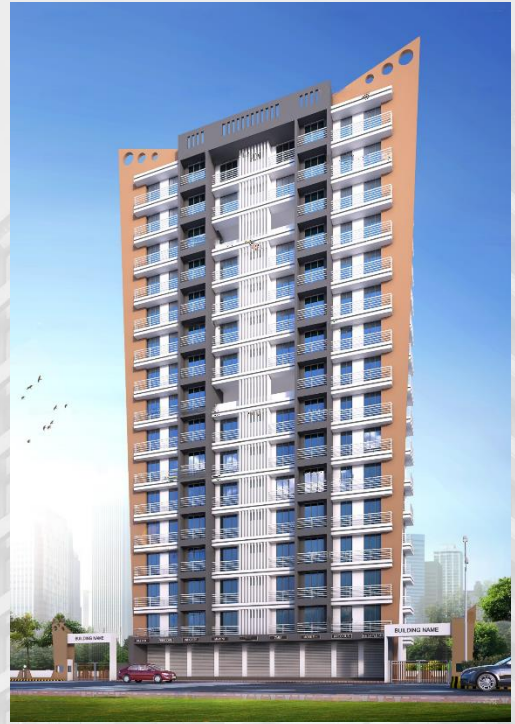

Project Name : M/s. Vaishnavi Gold Homes
 Location : Owala , Thane (W)
 Approx. Cost : 9.47 Cr.
 Completion Year : 2024
 Construction Area : 47,372 sq. ft.



Project Name : Olivia Prime
 Location : Panchpakhadi, Thane (W)
 Approx. Cost : 25.45 Cr.
 Completion Year : - 2021
 Construction Area : - 1,01,784 sq. ft.



Project Name : Prathamesh Tower
 Location : Boriwade , Thane (W)
 Approx. Cost : 10.86 Cr.
 Completion Year : 2012
 Construction Area : 89,559 sq. ft.



Project Name : Parshwanath Galaxy
 Location : Kasarwadavali , Thane (W)
 Approx. Cost : 7.50 Cr.
 Completion Year : 2010
 Construction Area : 47,296 sq. ft.



Project Name : M/s Goodwill Property
 Location : Owala, Thane (W)
 Approx. Cost : 3.30 Cr.
 Completion Year : 2020
 Construction Area : 14,730 sq. ft.



Project Name : M/s Mangalmurti Ent.
 Location : Louiswadi, Thane (W)
 Approx. Cost : 6.25 Cr.
 Completion Year : 2024
 Construction Area : 26,028 sq. ft.



Project Name : Vaishnavi Bhavan
 Location : Owala , Thane (W)
 Approx. Cost : 1.80 Cr.
 Completion Year : 2013
 Construction Area : 17,135 sq. ft.



Project Name : M/s JVM Spaces
Location : Bhayanderpada, Thane (W)
Approx. Cost : 7.50 Cr.
Completion Year : 2020
Construction Area : 51,617 sq. ft.



Project Name : Arihant Plaza Phase I & II
Location : Owala , Thane (W)
Approx. Cost : 3.52 Cr.
Completion Year : 2009



Project Name : Anand Dham
Location : Uthalsar , Thane (W)
Approx. Cost : - 3.62 Cr.
Completion Year : 2012



Project Name : M/s Dimpi Infra Pvt. Ltd.
Location : Kalamboli, Navi Mumbai.
Approx. Cost : 1.45 Cr.
Completion Year : 2012
Construction Area : 17,885 sq. ft.



Project Name: Aakar Residency
Location: Kavesar, Thane (W)
Approx. Cost: 8.20 Cr.
Completion Year : 2013
Construction Area: - 79,184 sq. ft.



Project Name : M/s Deeplaxmi Developer

Location : Kamatghar, Bhiwandi , Thane.

Approx. Cost: 25.80 Cr.

Completion Year : 2023

Construction Area : 2,12,321 sq. ft.



Project Name : M/s. Thakkar Developers

Location : Charai , Thane (W)

Approx. Cost : 2.50 Cr.

Completion Year : 2021

Construction Area : 10,500 sq. ft.



Project Name : Gururaj Enterprises

Location : Boriwade , Thane (W)

Approx. Cost : 1.60 Cr.

Completion Year : 2010

Construction Area : 22,828 sq. ft.



Project Name : Shantai
 Location : Bhayanderpada, Thane (W)
 Approx. Cost : 3.80 Cr.
 Completion Year : 2021
 Construction Area : 25,346 sq. ft.



Project Name : Laxmi Plaza
 Location : Patlipada , Thane (W)
 Approx. Cost : 5.90 Cr.
 Completion Year : 2012
 Construction Area : 46,410 sq. ft.



Project Name : M/s Sai Builders & Developers.
 Location : Owala, Thane
 Approx. Cost : 2.85 Cr.
 Construction Area : 12,912 sq. ft.



Project Name : New Vegas Plaza
 Location : Owala , Thane (W)
 Approx. Cost : 7.30 Cr.
 Completion Year : 2014
 Construction Area : 69,550 sq. ft.



Project Name : Sai Leela C.H.S. Ltd.
 Location : Panchpakhadi, Thane (W)
 Approx.Cost : 3.94 Cr.
 Completion Year : 2012
 Construction Area : 28,950 sq. ft.



Project Name : Shiv Krupa Construction
 Location : Chendani, Thane
 Approx.Cost : - 1.30 Cr.
 Completion Year : 2012
 Construction Area : 8,700 sq. ft.



Project Name : Shri Siddhivinayak Ent.
 Location : Majiwade, Thane (W)
 Approx. Cost : 1.35 Cr.
 Completion Year : 2018
 Construction Area : 21,358 sq. ft.



Project Name : M/s. Shreenath Developer
 Location : Dhobi Ali , Thane (W)
 Approx. Cost : 2.44 Cr.
 Completion Year : 2012
 Construction Area : 22,267 sq. ft.



Project Name : Vegas Plaza
 Location : Owala , Thane (W)
 Approx.Cost : 2.65 Cr.
 Completion Year : 2009
 Construction Area : 50,970 sq. ft.



Project Name: Shree Swami
 Samarth Apartment
 Location :Tal. Karad, Dist. Satara.
 Approx.Cost: 0.65 Cr.
 Completion Year : 2014
 Construction Area : sq. ft.



Project Name : Hare Krishna Paradise
 Location : Karanje , Satara
 Approx. Cost : 3.30 Cr.
 Completion Year : 2013
 Construction Area : 31,043 sq. ft.



Project Name : Kavya Hill View
 Location : Boriwade , Thane (W)
 Approx. Cost : 12.80 Cr.
 Completion Year : 2012
 Construction Area : 76,412 sq. ft.



Project Name : Ganga Apartment
 Location : Owala, Thane (W)
 Approx. Cost : 1.75 Cr.
 Completion Year : 2011
 Construction Area : 16,600 sq. ft.



Project Name : Kokan Putra C.H.S. Ltd.
 Location : Pawar Nagar , Thane (W)
 Approx. Cost : 2.33 Cr.
 Completion Year : 2009
 Construction Area : 22,140 sq. ft.



Project Name : M/s Om Sai Krupa
 Location : Pawar Nagar , Thane (W)
 Approx. Cost : 2.72 Cr.
 Completion Year : 2008
 Construction Area : 45,425 sq. ft.



Project Name : Vishnu Sadan
 Location : Kasarwadavali , Thane (W)
 Approx. Cost : 0.86 Cr.
 Completion Year : 2009



Project Name : Sai-Sumangal C.H.S. Ltd.
 Location : Lokmanya Nagar , Thane (W)
 Approx. Cost : 2.10 Cr.
 Completion Year : 2008
 Construction Area : 34,830 sq. ft.



Project Name : Snehbandh C.H.S. Ltd.
 Location : Yashodhan Nagar, Thane (W)
 Approx. Cost : 1.75 Cr.
 Completion Year : 2010
 Construction Area : 22,454 sq. ft.



Project Name : Happy Home
 Location : Panchpakhadi, Thane (W)
 Approx. Cost : 4.64 Cr.
 Completion Year : 2015
 Construction Area : 30,348 sq. ft.



Project Name : Vintage Point
 Location : Dhokali , Thane (W)
 Approx. Cost : 3.05 Cr.
 Completion Year : 2012
 Construction Area : 29,243 sq. ft.



Project Name : Ambar Codename Tower 34

Location : Owala, Thane (W)
 Approx. Cost : 30.90 Cr.
 Construction Area : 2,31,348 sq. ft.



Project Name : Purushottam Nayan

Location : Wadavali, Thane (W)
 Approx. Cost : 14.76 Cr.
 Construction Area : 1,63,363 sq. ft.



Project Name : M/s Sai Omkar Developers

Location : Bhayanderpada , Thane (W)
 Approx. Cost : 7.65 Cr.
 Construction Area : 74,500 sq. ft.



Project Name : Larkins Nest

Location : Wadavali, Thane
 Approx. Cost : - 26.29 Cr.
 Construction Area : - 1,19,103 sq. ft.



Project Name : Laabh Aura

Location : Bhadwad, Bhiwandi, Thane

Approx. Cost : 11.55 Cr.

Construction Area : 91,597 sq. ft.



Project Name : Laabh Gloria

Location : Wadavali, Thane (W)

Approx. Cost : 4.30 Cr.

Construction Area : 56,850 sq. ft.



Project Name : Kavya Mira Realty

Location : Boriwade, Thane (W)

Approx. Cost : 31.05 Cr.

Construction Area : 2,57,088 sq. ft.



Project Name : Gulmohar

Location : Majiwade, Thane (W)

Approx. Cost : 1.30 Cr.

Construction Area : 14,528 sq. ft.



Project Name : Horizon Palm 3
 Location : Owala, Ghodbunder Rd., Thane (W)
 Approx. Cost : 1.95 Cr.
 Construction Area : 47,925 sq. ft.



Project Name : White House
 Location : Wadavli , Thane (W)
 Approx. Cost : 22.89 Cr.
 Construction Area : 1,14,469 sq. ft.



Project Name : Aakar Residency
 Location : Kavesar, Thane (W)
 Approx. Cost : 8.20 Cr.



Project Name : M/s. K. D. V. Enterprises

Location : At. Majiwade , Thane (W)

Approx. Cost : 6.09 Cr.

Construction Area : 30,454 sq. ft.



**Project Name : Shri. Shankar Pawar
Residence**

Location : Owala , Thane (W)

Approx. Cost : 2.50 Cr.

Construction Area : 10,000 sq. ft.



Project Name : Yashashree Paradise

Location : Dhokali , Thane (W)

Approx. Cost : 4.35 Cr.

Construction Area : 25,980 sq. ft.



Project Name : M/s. Mangal Developers

Location : Majiwade , Thane (W)

Approx. Cost : 1.95 Cr.

Construction Area : 25,980 sq. ft.



Project Name : Kavya Hill View
 Location : Ghodbunder Road, Thane.

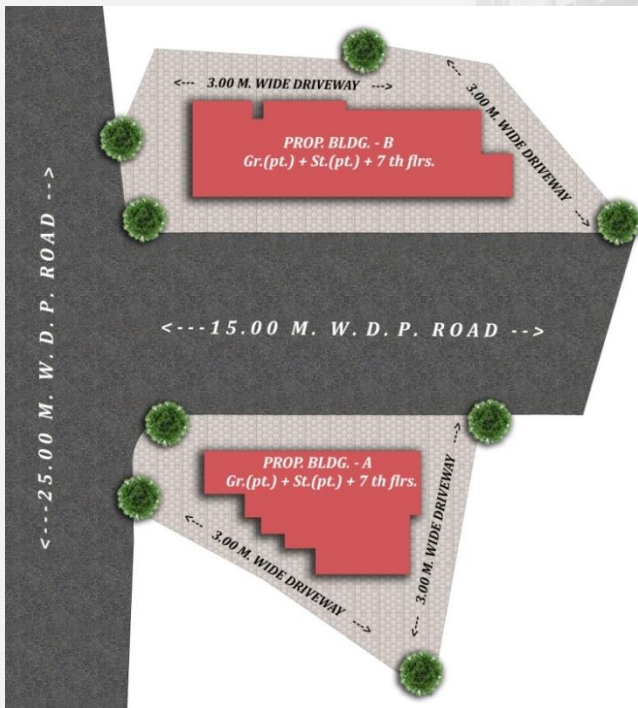

Project Name : M/s. Sunraj Enterprises
 Location : Village Parsik, Thane (W)
 Approx. Cost : 9.74 Cr.
 Construction Area : 36,007 sq. ft.

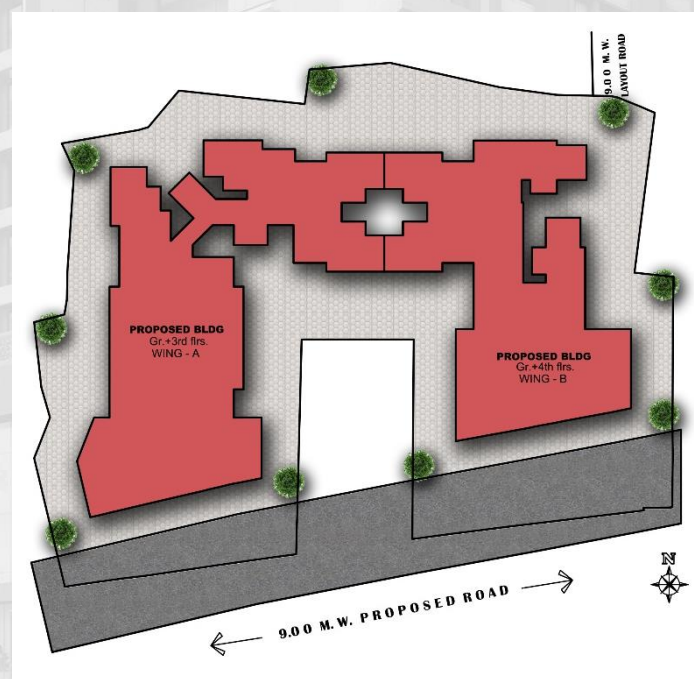

Project Name : M/s Bhagalaxmi Builders and Developers
 Location : Nagaon, Bhiwandi. Thane.
 Approx. Cost : 16.00 Cr.
 Construction Area : 73,000 sq. ft.

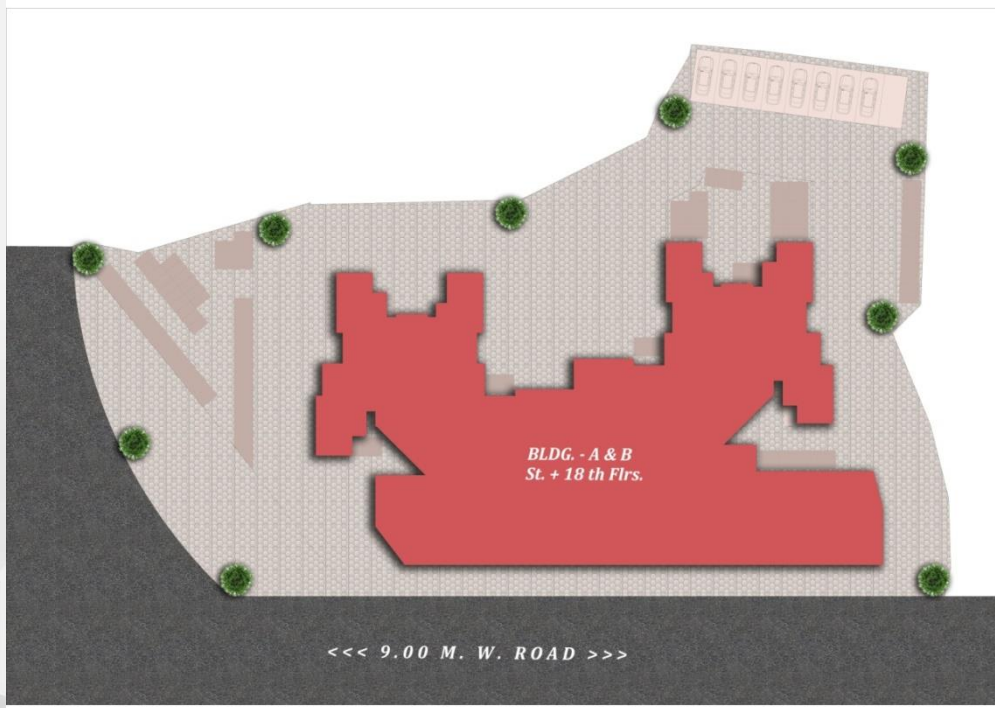

Project Name : Shree Satish Thakur
 Location : Mogharpada Dist- Thane(W)
 Project Cost : 25.54 Cr.
 Construction Area : 1,41,902 sq. ft.



Project Name : Smt. Z. Z. Hussain
 Location : Naupada, Dist- Thane(W)
 Project Cost : 3.00 Cr.
 Construction Area : 12,500 sq. ft.



M/S PRIDE PROPERTY DEVELOPERS
GREENFIELD PROJECT



RESIDENTIAL LAYOUTS

COMPLETED PROJECTS - 06
ONGOING PROJECTS - 11
UPCOMING PROJECTs - 00



Project Name : Om Sai Plaza
Location : Wadavali, Thane (W)
Approx. Cost : 18.55 Cr.
Completion Year : 2010
Construction Area : 1,54,000 sq. ft.



Project Name : Sahajanand Park
Location : Village Amli , Silvasa.
Approx. Cost : 13.78 Cr.
Construction Area : 1,92,274 sq. ft.



Project Name : Arihant City Phase – I
Location : Temghar , Bhiwandi , Thane .
Approx. Cost : 78.40 Cr.
Completion Year : 2020
Construction Area : 6,26,375 sq. ft.



Project Name : Horizon Flora
Location : Bhayanderpada, Thane
Approx. Cost : - 24.60 Cr.
Construction Area : - 1,53,821 sq. ft.



Project Name : M/s Amardeep Construction
Location : Ambedkar Nagar , Mulund (E)
Completion Year : 2020
Approx. Cost : 125.00 Cr.
Construction Area : 4,62,290 sq. ft.



Project Name : Maitri Developers
Location : Kankavali, Ratnagiri.
Approx. Cost : 25.00 Cr.
Construction Area : 64,535 sq. ft.



Project Name : Arihant City Phase –II
Location : Bhadwad, Bhiwandi, Thane.
Approx. Cost : 167.80 Cr.
Construction Area : 21,33,781 sq. ft.



Project Name : Pehla Ghar 1
Location : Bhadwad, Bhiwandi, Thane.



Project Name : Periwinkle Complex
Location : Mogharpada , Thane (w)
Approx. Cost : 25.41 Cr.



Project Name : M/s. Laabh Developers
Location : Bhadwad , Bhiwandi , Thane
Approx. Cost : 35.30 Cr.
Construction Area : 2,84,880 sq. ft.



Project Name: Pushpanjali Residency

Location: Owala, Thane.

Approx. Cost : 275.00 Cr.

Construction Area : 10,70,000 sq. ft.



Project Name : Laabh Enclave

Location : Temghar, Bhiwandi

Approx. Cost : 56.85 Cr.

Construction Area : 2,27,410 sq. ft.



Project Name : M/s. Charbhuja Developers

Location : Wadhe, Tal . & Dist- Satara

Approx. Cost : 16.90 Cr.

Construction Area : 1,58,698 sq. ft.



Project Name : Pehla Ghar -2

Location : Bhadwad , Bhiwandi , Thane

Plot Area : 14.00 Cr.

Approx. Cost : - 91,597 Cr.

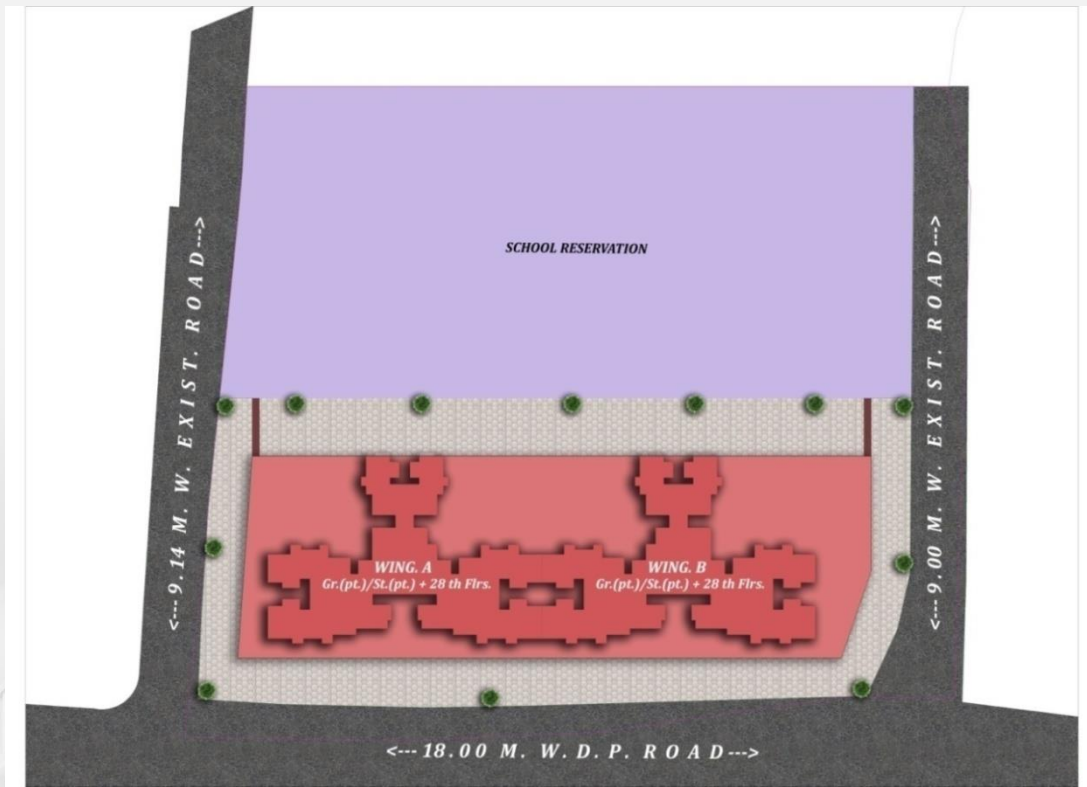

Project Name : Uthalsar School

Location : Uthalsar, Sector No. 2 , Thane

Approx. Cost : 150 Cr.

Construction Area : 5,54,637 sq. ft.



Project Name : M/s Amardeep Construction

Location : Kaneri , Bhiwandi , Thane (W)

Approx. Cost : 105.00 Cr.

Construction Area : 3,99,140 sq. ft.



Project Name : M/s. Galaxy Builders

Location : Titwala, Tal. Kalyan , Dist- Thane

Approx. Cost : 89.50 Cr.

Construction Area : 3,32,155 sq. ft.



THANK YOU